



DV-EL1000

Portable Emergency Work-Light

SPECIFICATIONS

Lamp

21W LED worklight | 50000hrs of lamp life | Color temperature of 6000K

Run time

EL1000: 14 hours | EL1000S: 7hours

Battery

Type: Lithium ion | Capacity: DC14.8V 23200mAh

Weight

18.2kg (including lamp)

Size

350(W) x 260(L) x 570(H)mm (Case) | 350(W) x 260(L) x 2100(H)mm (Set-up)

Charging voltage (IN)

AC110 - 220V (Adapter) | DC12V - 24V (Car cigarette charger)

Charging voltage (OUT)

12V (Lamp) / 5V (Mobile device)

Water resistance

Water resistant (IP67)

CONTROLS

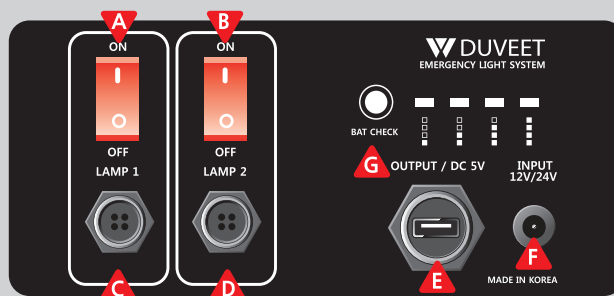

- A** LAMP ON/OFF SWITCH
- B** LAMP ON/OFF SWITCH
- C** 12V OUTPUT (LAMP)
- D** 12V OUTPUT (LAMP)
- E** 5V OUTPUT (MOBILE DEVICE)
- F** 12V~24V DC INPUT / AC ADAPTOR INPUT
- G** BAT CHECK BUTTON

COMPONENTS



Carrying case



Lamp (EL1000S)



Connecting cable



Control panel

Address

Banwolnam St. 88th,
Hwasung-si Gyeonggi-do, 18383
Republic of Korea

Contact Info

Tel: 031-217-7011
Fax: 031-217-7013
Email: david@duveet.com
Website: www.duveet.com